

A large, jagged ice formation floats in the dark ocean under a cloudy sky. The ice has a blueish tint and a complex, layered structure. In the distance, a small boat is visible on the water.

QUIXOTE EXPEDITIONS

INTIMATE ANTARCTICA

OCEAN TRAMP

ANTARCTICA

FLY-SAIL

EXPEDITION

Sail or FLY to the White Continent and experience Antarctica how it is supposed to be experienced. First hand, up close, personal. Spend time watching penguins, whales, seals. Explore old whaling stations, science bases...

The best of all worlds – an intimate up-close Antarctica experience on an Expedition Sailing Yacht combined with the convenience and time-saving travel of Flying across the Drake!

Explore Antarctica on an Expedition Sailboat where we will encounter



penguin colonies, breaching whales, and leopard Seals. Each day is something new – we take in what Antarctica gives to us, which the flexibility of a small yacht allows us to do. We will visit penguin colonies, watch many types of seals. Explore from eye level with zodiac tours and kayaks. Plus if the weather allows anyone interested can sleep a night ashore! We will be reminded of the brave souls who have come before us when we see

remains of old whaling stations. If we are lucky we may even get to visit an active station while in the peninsula.

No matter what we do and no matter what the weather, your time in Antarctica will be one of a life time. Full of fantastic photos, unforgettable evening zodiac rides through the ice, Sculpted icebergs floating past. It is unlike any other place on the planet.

The Fly in and fly out trips start and end in



Punta Arenas, Chile. The fly one way and sail the other starts in Ushuaia, Argentina and ends in Punta Arenas, Chile.

SPECIAL RESEARCH SAILING TRIPS

On most of our voyages we will have a Guest Scientist who will be actively collecting data and doing research on the trip, and/or we will participate in Citizen Science projects.

Guests are invited to help with the science first hand!



SHIP

OCEAN TRAMP

Ocean Tramp is a 66 feet ketch rigged sailboat, with 5 cabins. She very comfortably can carry 8 guests plus four crew members. She is a very fast sailboat thanks to her long length, making for a short passage the sailing across the Drake. She is ideal for photographers, hikers, divers, scientists and all sort of expeditions that need a large capacity vessel with plenty of storage as well as the needed comfort when living on a sailboat for longer periods of time.

She has a broadband 4G radar, AIS, 3 VHF's, SSB Radio, 3 GPS, 2 echo sounders, autopilot, onboard PC, chart

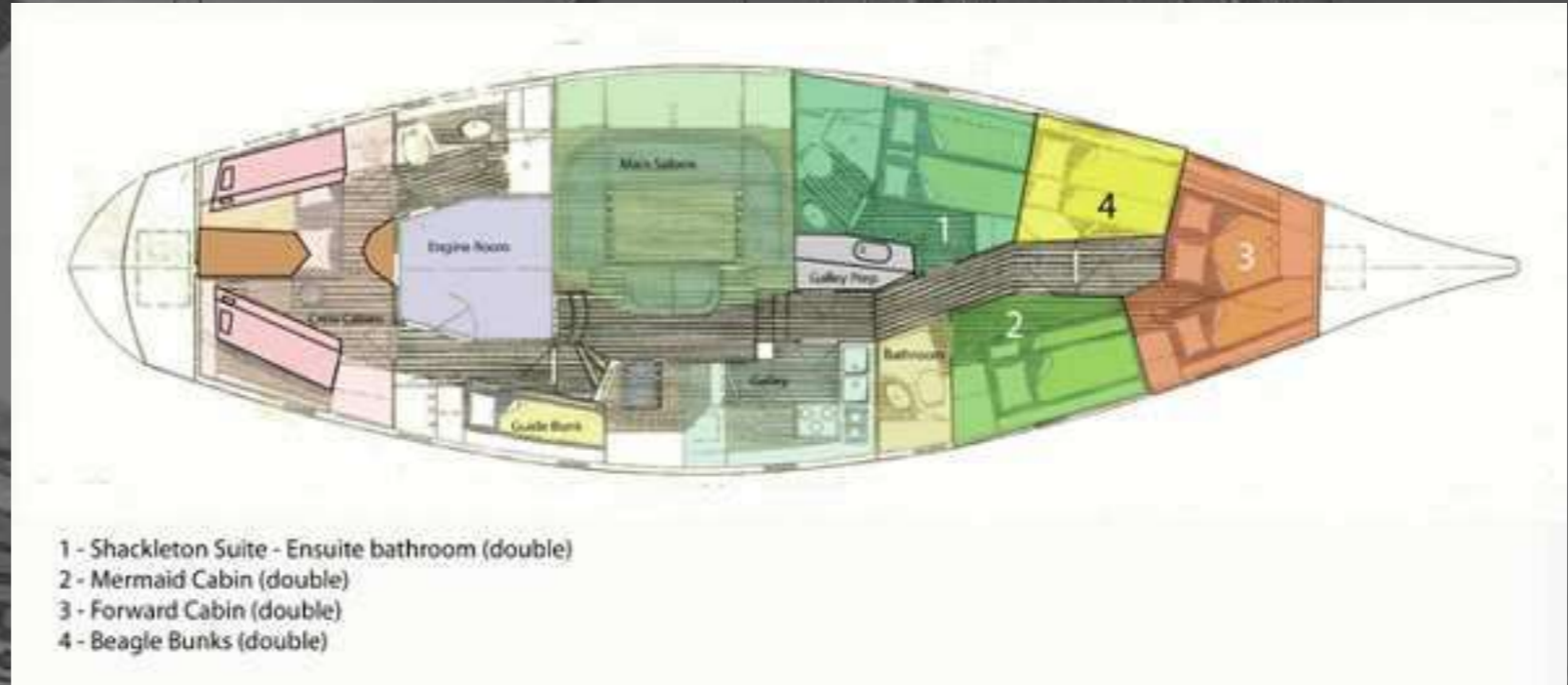

lotter, Satellite Phone with email and weather download capabilities, a large separate kitchen and a large saloon for 12 guests. She carries all the safety equipment required, including Epirb beacon, SART, a line throwing device, 2 liferafts, flares, Handheld VHF's, SOLAS lifejackets,

inflatable lifejackets, Full Co2 engine room firefighting system, etc.

She is a very sturdy and comfortable boat with huge forward and aft decks for wildlife watching- we are very happy with her!



SHIP

OCEAN TRAMP

TECHNICAL INFORMATION

- Designer: Horst Glacer & Kurt Reinke.
- Type: Hydra Duo 66.
- Shipyard: Alu Yachtbau gmb, Germany
- Built: 1997.
- LOA: 19.55 m.
- LWL: 17.10 m.
- Beam: 5.35 m.
- Draft: 2.20 m.
- Engine: Perkins Sabre 215 HP.
- Genset Kohler diesel 5 KW & Portable 2KW Honda generator + 1KW portable Honda
- Displacement: 32.00 tons.
- Fully protected Bridge for safety and comfort when sailing in rough/cold weather.
- State-of-the-Art navigation electronics

- 5 Cabins, 3 heads with hot running water and hot showers.
- 2500 lts fresh water capacity.
- Fresh water maker 120 lts per hour
- Diesel Capacity 5000 Lts – 4000miles range @ 7 knots.
- Black and Grey Water holding tank. Sewage treatment plant
- 4.3 meters Inmar tender with Yamaha 20 HP Four Stroke
- LED TV in saloon for movies and presentations.
- All cabins equipped with 12 volts plug.
- Charging station for electronics, with 12v and 220 volts.
- Cozy double cabins for privacy, with double and single bunks.

- Ample library including Glaciology, Geology, Birds, Mammals, Plants, Fuegian history and local related books.
- Diving compressor.

ECO-FRIENDLY FEATURES

- All LED Lights throughout the boat
- Wind Generator
- Solar Panel
- Motion Sensor faucets
- Flow restrictors on faucets
- We produce our own fresh water
- Sails!





SAIL DOWN TO ANTARCTICA / FLY BACK

19 DAYS LONG. TWO WEEKS IN ANTARCTICA. GROUP SIZE: MAX. 8

DEC 3RD TO 21ST 2023

<i>Day</i>	<i>Description</i>
1	Meet at The sailboat in the morning for a full briefing and orientation and in the afternoon, depart from Ushuaia and start sailing across the Drake Passage.
2 to 4	Sail the Drake Passage. Get ready for a very unique days that few get to experience. As you sail east out of the the Beagle channel, you'll pass through historic waters traversed by Darwin. You'll head south past the infamous Cape Horn. Keep your eyes out for albatross as the Southern Ocean is their home. You may even help the crew a bit with some time at the helm.
5 to 18	Explore Antarctica on an Expedition sailing yacht. Each day will be different and can include zodiac tours, landings at penguin colonies, exploring historic scientific bases and whaling sites, kayaking. The flexibility allows you to take full advantage of whatever Antarctica gives to us – be it an incredible southern sunset or a breaching whale. We can stop and enjoy – not just once, but every time.



WHAT'S INCLUDED

SAIL DOWN TO ANTARCTICA / FLY BACK

✦ Flights Punta Arenas – Antarctica

✦ Muckboots for use in Antarctica

✦ Meals and Accommodation in Antarctica

✦ Kayaking and camping

✦ Celebration dinner in Punta Arenas

✦ Wine with dinner

✦ Luggage up to 50lb/23kg

WHAT'S NOT INCLUDED:

✦ Flights to/from home to Ushuaia / Punta Arenas

✦ Insurance: medical, evacuation, travel

✦ Personal equipment and clothing

✦ Delays due to weather

✦ Meals and accommodation in Ushuaia / Punta Arenas before and after the trip

✦ Communication charges





FLY IN & OUT

14 DAYS LONG. GROUP SIZE: MAX. 8
 JAN 29 TO FEB 11TH 2024

Day	Description
Before flight	Meet at our office at 5 pm (Actual time TBC), for a Safety Pre-Flight Briefing.
1	We'll pick you up from your hotel and transport you to the airport. Depart from Punta Arenas and fly across the Drake Passage. Join the Expedition sailing yacht at King George Island and start your Antarctic Adventure.
2 to 13	Explore Antarctica on an Expedition sailing yacht. Each day will be different and can include zodiac tours, landings at penguin colonies, exploring historic scientific bases and whaling sites, kayaking. The flexibility allows you to take full advantage of whatever Antarctica gives to us – be it an incredible southern sunset or a breaching whale. We can stop and enjoy – not just once, but every time.
14	Return to King George Island and board your flight to Punta Arenas. Look out your window and get a last glimpse at the white continent. As you return back to Punta Arenas join your fellow passengers for a celebration dinner

Remember to visit our Instagram @quixote_expeditions to see more pictures and experiences of our latest trips.



WHAT'S INCLUDED

FLY IN & OUT

- ✦ Flights to/from Punta Arenas – Antarctica
- ✦ Muckboots for use in Antarctica
- ✦ Meals and Accommodation in Antarctica
- ✦ Kayaking and camping
- ✦ Celebration dinner in Punta Arenas
- ✦ Wine with dinner
- ✦ Luggage up to 50lb/23kg

WHAT'S NOT INCLUDED:

- ✦ Flights to/from home to Punta Arenas
- ✦ Insurance: medical, evacuation, travel
- ✦ Personal equipment and clothing
- ✦ Delays due to weather
- ✦ Meals and accommodation in Punta Arenas before and after the trip
- ✦ Communication charges



IS THIS EXPEDITION FOR ME?

Sailing to remote areas means that we are away from everything! That also means that if we need medical assistance it can be days away. It also means that we have no access to emails, phone, facebook, etc, for the duration of the trip.

Sailing on an Expedition Yacht means that the cabins and common places are small and we all the crew and passengers share pretty much everything. It can be considered as an Adventure in its true meaning!

Having said that, we operate one of the biggest and more comfortable sailing boats in the area, with private double cabins, water maker, 4 bathrooms, hot showers now and then, and a 24/7 running heater keeping the inside dry, warm and cozy!

Am I in good shape for participating on these expeditions?

If your answer to the questions below are YES, then yes! You are fit to join us!

Any questions, Please ask us, happy to have a chat on the phone or put you in contact with past guests.

- Can you stay without external medical assistance for the duration of the Expedition?
-it could be up to 20 days
- Can you swim or float?
- Do you have good balance: Can you stay standing on a bus/metro/train with little to minimum holding in normal conditions?
- Can you embark/disembark from a zodiac to a beach with little swell?
- Can you walk 10 blocks/1 mile/ 2 km, without getting exhausted?
- Can you climb a 6ft / 2m vertical ladder?
- Are you aware that you are going to a remote area, with nophone/email/contact/ etc with external people/family/etc for the length of your trip? (note: we have a satellite coms and we can send out Facebook updates to family and friends)



IS THIS
EXPEDITION FOR
ME?

FAQ'S

I'M NOT A SAILOR – IS THAT OK?

YES! Please join us. Anyone with a sense of adventure and a desire to spend quality time in Antarctica will find our trips enjoyable. We teach you everything you need to know. Sailors and non-sailors alike both have incredible experiences.

I'M A PHOTOGRAPHER – IS THIS TRIP FOR ME?

This is a great trip for photographers, especially those looking to get the perfect shot and light. Our size offers us incredible flexibility. We can help you get some great shots and we can take advantage of the weather and the light! Being on a small boat means the deck is very close to wildlife -no need to jump into the zodiacs!
Also, our landings are for several hours so you can wait for the perfect shot and light.



HOW WILL I KNOW WHAT TO BRING?

We will send you a list of gear you will need. If you have winter clothes, most of it you will already have. We'll provide you with Antarctic Insulated boots and a warm hat!

WHAT ARE THE CABINS LIKE?

Our cabins are some of the most comfortable available for yachts of our size. We have private double

cabins, and even some with a private bathroom and shower.

Each cabin has a door that can be closed, they are fitted with warm and cozy duvets and storage space for your things. A luxury suite it is not, however each cabin gives you a place to call your own for the duration of the journey.



HOW WILL WE EXPLORE ANTARCTICA?

When we are in Antarctica our yacht will act like a base camp. Some days we will travel other days we will stay put, it will be based on weather and our own interest -if we love the place, we stay an extra day! This is the beauty of exploring on a small yacht.

Once we are anchored, we will launch the zodiacs to explore. On shore we will be able to freely move around, explore and hike and enjoy long landings and feel the remoteness of Antarctica. Again, being only a little bunch of friends, we can take advantage of whatever Antarctica has to offer us!

We also bring kayaks and can use them to explore at eye level, free of extra charge!

WILL I GET SEASICK?

Everyone's a little different, but we highly recommend bringing some seasickness pills with you. We generally take them as a preventive measure.

Food

On-board you will eat hearty well-made delicious home cooked food. Lunch is often warm soups and sandwiches, while dinner is the big meal of the day and can be a wide ranging based on the cook and crews' favorites. The food might be described as healthy, comforting fare. We also always have snacks available during the day and water ready for coffee or tea. If you do have any special snacks or teas that you can't live without, we recommend bringing some with you.

The goal of this expedition is to provide excellent quality time in Antarctica, taking full advantage of the "Fly Cruise" program, with long and exclusive landings and limited number of passengers onshore. This is a True Expedition style trip and not a "culinary" cruise.

Passengers with dietary needs:

Our cook will make his/her best effort to meet your needs, but some flexibility and understanding is also asked.

IS IT DANGEROUS TO GO TO ANTARCTICA IN A YACHT?

Yachts in the Antarctic Peninsula have a very good track record. This is due to vessels taking a very high regard to safety. Safety is a core element of our business. Every decision we make is based on a risk analysis. Crossing the Drake could indeed be dangerous. Sailing in Antarctica could be dangerous. Then again crossing the street could also be dangerous – cars whiz by at 60 miles an hour. However just like you taking precautions when crossing the street, we take extreme cautions when sailing.

We continuously watch the weather, we are a surveyed vessel, which means we MUST comply with all safety regulations.

We have strict requirements for lifejacket use. That being said, each person onboard must also use good judgement. If you follow what the Captain says you will be in good hands.



WHAT IS INCLUDED?

We include the transfers from your hotel in Punta Arenas to the airport, and the same on the way back. And once you are onboard everything is included. – port fees, meals, wine with meals. We also provide your basic safety equipment including life jackets. What is not included – flights to/from your home to Punta Arenas/Ushuaia, airport transfers, and REQUIRED evacuation insurance. Accommodation before and after the trip is not included.

DO I NEED TO FILL OUT A MEDICAL FORM?

Yes. The places we go are quite remote and while what we do is safe, it does require some physical activity. Once you sign up for a trip we will require you to give us a medical form that is signed by a doctor.

WHEN DO I NEED TO ARRIVE TO PUNTA ARENAS TO BOARD THE FLIGHT TO ANTACTICA?

You need to arrive at Punta Arenas 36 hours prior to the date of the flight to Antarctica. The reason is that this flight could be advanced due to adverse weather approaching. Also, it could happen that one of your

bags doesn't make it and get delays somewhere, and by arriving earlier you have time to wait for it. Finally, the night before the flight, we will all meet at our office for a Safety Briefing where we will explain how the Charter Flight to Antarctica will work, at what time it will depart (there is no fixed timing, as it's weather dependent) and what to expect the day of the flight.

WILL WE HAVE INTERNET ONBOARD?

We have satellite communications for basic email check once a day. Although one of the wonderful aspects of this trip is it allows you to unplug and get away from emails, phone calls, etc. We encourage everyone to tell their friends and families to subscribe to our blog and like us on facebook. Then they can get updates while you are here with us. Our guests and their families have appreciated these "news" updates in the past. They can also follow our track on a google map in our website, as we have a tracking system that plots our position every few hours. Also, keep in mind that satellite coms are subject to break down, so we can't guaranty that you will have access to your emails.

IS ALCOHOL ALLOWED ONBOARD?

Yes! If we are underway sailing in potentially rough weather, then we do not drink, as it is not in the interest of safety for crew and guests. If we are having a smooth sailing or we are comfortably in a cove for the night then indeed, we all enjoy a nice glass of Argentine Malbec or Chilean Cabernet Sauvignon wine with our meal. We also have beers and Gin & Tonics with glacier ice for happy hour! Alcohol consumption is at the discretion of the captain and inebriation will not be tolerated.

I HAVE SEEN OTHER YACHTS / CRUISE SHIPS FOR CHEAPER:

Correct – Although this trip is 14 days long in Antarctica, with virtually zero time wasted crossing the Drake passage (your regular cruise ship will take 2 days each way to cross the Drake). If you consider the cost per day in Antarctica, you'll see that this trip has pretty much the same cost per day of any other similar expedition on larger cruises, although with the benefit on only being 8 or 12 guests, flying across the Drake in just 2 hours, and having 2 weeks to explore, meaning you'll get the most chances of visiting most of the places, even if weather is not great.



Also, We pride ourselves on being one of the most professional small vessels operators. Our Yachts have full insurance for the transportation of passengers and they are certified by its flag to operate commercially. Our crew is also certified for crewing commercial vessels. We have all required safety gear and we fly down an inspector from the USA (to Ushuaia or the Falklands) to check and certify it. Our boats are maintained to a high standard, and we conduct a good amount of Preventive Maintenance - this is replacing parts before they break. All the above is expensive, very expensive! But we know you are looking for the experience of a lifetime and the last thing we want is a broken part to ruin or end an expedition of our clients. Our goal is to do our best for not waste your time and money and deliver the best Antarctic Experience you can get! We believe the investment on our side (and on yours) leads to a much safer and ultimately better experience in Antarctica!



GUESTS COMMENTS

The boat crew was incredible, from the Captain to the Chef, they took such good care of us from safety and comfort to making sure we were happy and having fun. They were always ready, always kind and smiling. I miss them already. Grace D.

The special thing was the crew and well they took care of us. Our happiness was as important as physical needs. They treated us all as individuals and got to know each of us and what we liked. They also made us laugh for the entire trip. Laura M.

The trip far exceed my expectation, great boat, amazing crew, and Antarctica is stunning, so many whales, so many kinds of seals, penguins, everywhere! Vanesa S.

This trip exceeded my expectations and in the seventh continent, plus 60+ countries I have travelled, this ranks as the best experience, or if not, in the top 5, which are difficult to compare because really change my perspective on the planet, the environment and humankind. Fred M.

Large variety of landings. By far this trip exceeded my expectations. Susan L.



QUIXOTE EXPEDITIONS

INTIMATE ANTARCTICA



IAATO Member

We are proud to be a member of IAATO – a community of Antarctic Tour Operators that works together to protect Antarctica and give the best possible experience to each and every visitor



Quixote Expeditions

We like to look at our trips as grand adventures, but with some fun thrown in; We hope they are personal journeys, but also a time to share with a special group of people in an amazing place. Together we share the experience, share ideas and conversations, making the trip not just about the place, but the people we've shared it with.



Leave No Trace Partner

We are proud to be a partner with Leave No Trace and support the seven Leave No Trace Principles on our trips.